



Bramley Road, Birmingham, B27 6TR

**SHELDON  
BOSLEY  
KNIGHT**

LAND AND  
PROPERTY  
PROFESSIONALS

# Property Description

This beautifully presented two bedroom home has been recently refurbished, offering a fresh, modern living space ideal for tenants seeking comfort and convenience.

The property benefits from a brand new fitted kitchen, finished to a high standard, providing ample storage and workspace, along with new double doors allowing plenty of natural light into the room and create a seamless connection to the garden.

Internally, the property has been newly decorated throughout, complemented by brand new carpets, giving the entire home a clean and contemporary feel. A new central heating system has also been installed.

Situated in a popular residential location, the property is close to local amenities, transport links, and schools, as well as being a short drive from Acocks Green Village

Early viewing is highly recommended to appreciate the quality of this home.





# Key Features

- Refurbished Two Bedroom Home
- New Modern Fitted Kitchen
- New Carpets
- Newly Decorated
- New Central Heating System
- New Rear Double Doors
- Driveway Parking
- EPC Rating: D
- Council Tax Band: C

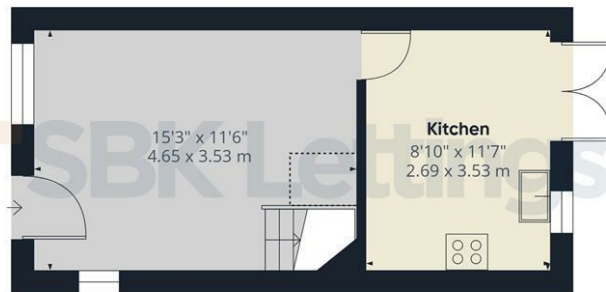

Ground Floor

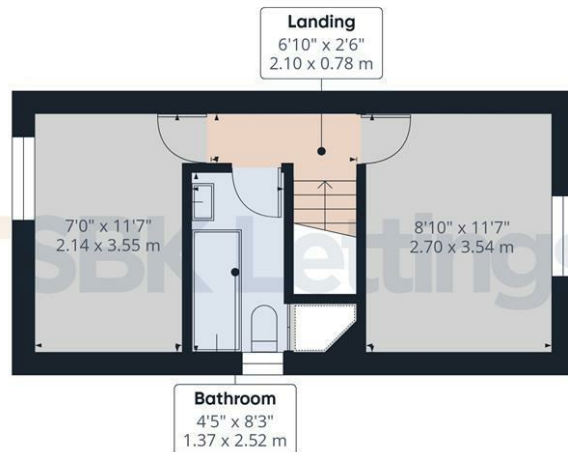

Floor 1



**Approximate total area<sup>(1)</sup>**

524 ft<sup>2</sup>  
48.7 m<sup>2</sup>

**Reduced headroom**

7 ft<sup>2</sup>  
0.7 m<sup>2</sup>

(1) Excluding balconies and terraces

**Reduced headroom**

Below 5 ft/1.5 m

Calculations reference the RICS IPMS 3C standard. Measurements are approximate and not to scale. This floor plan is intended for illustration only.

GIRAFFE360

**£1,200 PCM**